

Parts Diagram ■

Unite® Panel System

September 2024

.SSIZE = Select Size (* = for change-of-height at an intersection, use 3-way condition trim)

.SIZE = Select Size

.XX = Select Color

.BL = Black

.SET = Comes as RH & LH Set



Top Cap
48.0715.SIZE.XX

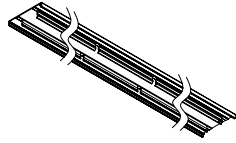

Continuous Top Cap
48.0717.SIZE.XX

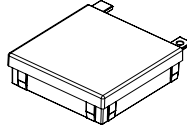

Dead-End
Intersection Cap
48.0091.XX

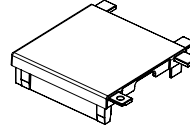

90 Degree
Intersection Cap
48.0092.XX

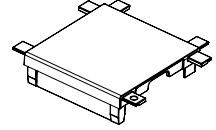

3-Way
Intersection Cap
48.0094.XX

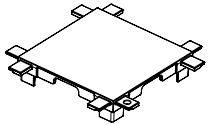

4-Way
Intersection Cap
48.0095.XX

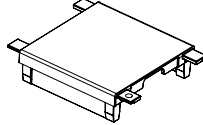

In-Line
Intersection Cap
48.0093.XX

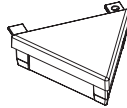

Dead-End 120
Intersection Cap
48.0096.XX

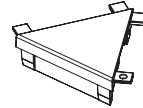

2-Way 120
Intersection Cap
48.0097.XX

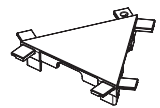

3-Way 120
Intersection Cap
48.0098.XX

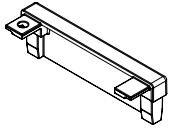

End-of-Run
Intersection Cap
48.0090.XX

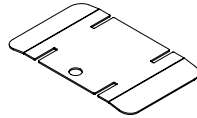

Top Cap In-Line
Splice Plate
48.0084.XX

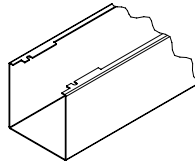

Dead-End Trim
48.0056.SSIZE

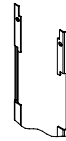

120 2-Way Trim
48.0060.SSIZE.XX

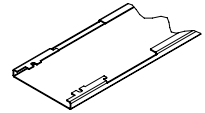

3-Way Condition Trim
48.0054.SSIZE.XX

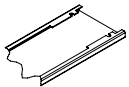

End-of-Run Trim
48.0050.SSIZE.XX

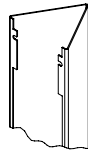

120 Dead-End Trim
48.0062.SSIZE

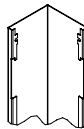

Corner Condition Trim
48.0052.SSIZE.XX

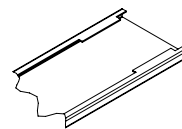

Change-of-Height Trim
48.0066.SSIZE*.XX

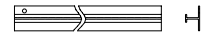

Fabric Segmented
Trim Channel
48.0048.SIZE.XX



Tile-to-Floor Trim Channel
48.0117.SIZE.XX



Bottom
Trim Channel
48.0049.SIZE.XX

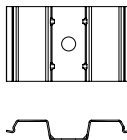

End-of-Run Clip
48.0080.XX

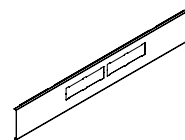

Steel Base Raceway
48.0100.SIZE.XX

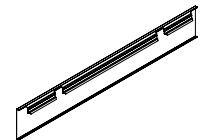

Base Raceway
without Knockouts
48.0109.SIZE.XX

Note: Load bar hook bracket hardware kits.

46.0052.B – Hardware kit for overhead models PRDF/PRDS/PRDL.

46.0052.X – Hardware kit for fully assembled Universal Overheads.

46.0052.E – Hardware kit for Unite Universal Low/Regular Shelf.

■ Unite® Panel System
Parts Diagrams

.XX = Select Color
.BL = Black
.SET = Comes as RH & LH Set

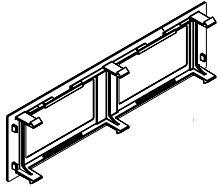

Power/Data Bezel
48.0104.XX



Bezel Filler Plate (2 per)
46.0074.XX

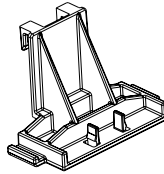

Raceway Hinge Clip
48.0103

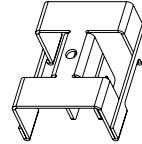

Wireway Bracket
48.0101



Universal Overhead
Panel Bracket
48.0261.SET

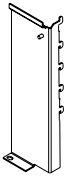

Underhead Bracket
48.00221.SET

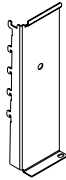

Wall Hanging Bracket
48.0222.SET



Load Bar Hook Bracket
(requires hardware kit, see note below)
46.2103.BL

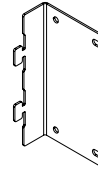

Tack/Marker
Board Bracket
48.0262.BL

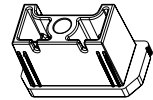

Glide Housing
48.0005

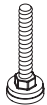

2" Table Glide
48.1186

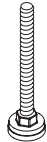

3" Panel Glide
48.0006

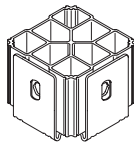

Connector Block
48.0802

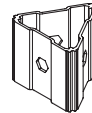

120° Connector Block
48.0009



Light Block (48", 64" or 80")
48.0800.XX

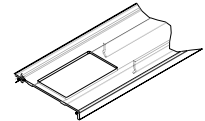

Power Pole Top Cap
48.0716.SIZE.XX

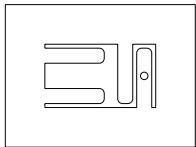

Power Pole
Ceiling Trim Plate
48.0076.XX

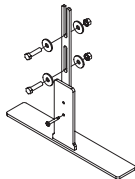

Stabilizer Support Foot
(end-of-run)
48.0856.XX

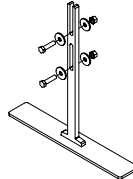

Stabilizer Support Foot
(mid-run)
48.0866.XX



Lock, Wksf. Supp.
1/4-20 x 2 1/4" Screw
48.0113

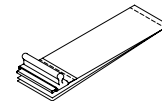

Velcro Wire Manager
WWM.X

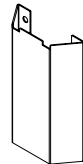

Foot Shroud
(for elevated base only)
48.0107.XX