

Parts Diagram ■

Strive® Seating
Task Armchair & Task Stool

March 2024

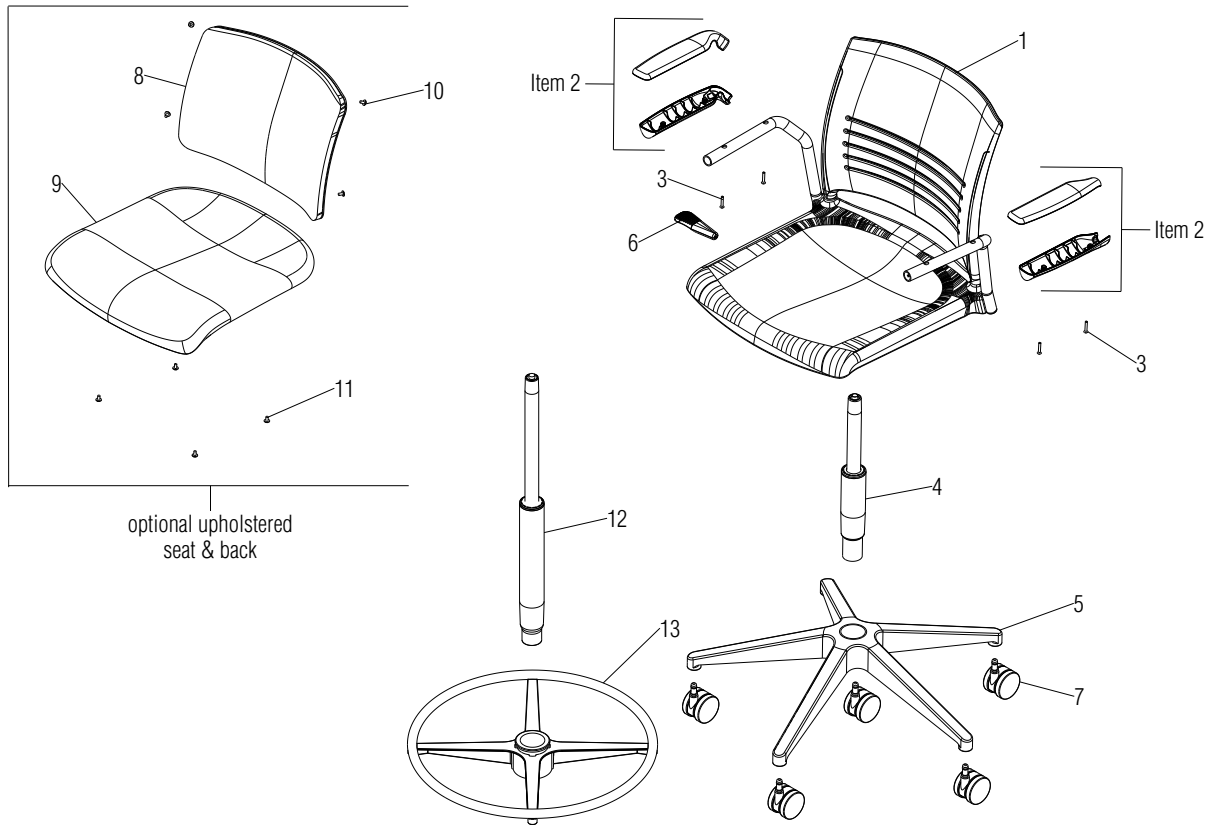

.XX = Select Color

Item 1 is a replacement Seat & Back (includes items 2, 3, & 6).

Item 4 is for the Task Chair only.

Items 12 & 13 are for the Task Stool only.

Item	Part Number	Item Description	Req Qty	Item	Part Number	Item Description	Req Qty
1	SRFP	Replacement Seat & Back, Poly	1	6	PT.06.6040.XX.X	Handle, Pedestal	1
	SRFU	Replacement Seat & Back, Upholstered Seat	1	7	09.0440.XX.X	Caster, 60mm Diameter Carpet (black or warm grey)	5
	SRFB	Replacement Seat & Back, Upholstered Seat & Back	1		09.0441.BL.X	Caster, 60mm Diameter Hard Floor (black only)	5
2	STV.CA.XX.X	Arm Cap Set, Right & Left Hand	1	8	STRBC	Assembly, Upholstered Backrest Cushion	1
3	13.6022.X	Screw, #8 x 7/8" PH OVL HD T-AB T/SCZ	4	9	STRRC	Assembly, Upholstered Seat Cushion	1
4	15.1084.X	Cylinder, Pneumatic Height Adjustment, Type D (chair only)	1	10	12.0055.CZ.X	Screw, #10-16 x 1/2" Type AB T/F BLK ZC	4
	15.1084.WG.X	Cylinder, Pneumatic Height Adjustment	1	11	12.0111.XX.X	Screw, #10-24 x 3/8" PTH M/S ZC w/ PATCH	4
5	46.2995.XX.X	Base, 5 Blade Cylinder	1	12	15.1002.X	Cylinder, Gas Seat Height Adjustment (stool only)	1
	SIFT.015.X	Aluminum Base, Grazie Task Chair	1	13	15.0120	Foot Ring, Stool 20" Twist-to-Lock	1