

Parts Diagram ■

Ruckus® Activity Table

October 2024

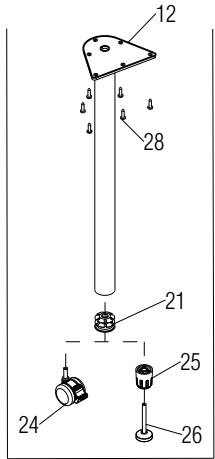

Item 1
(fixed height leg
for Kite and Diamond tables)

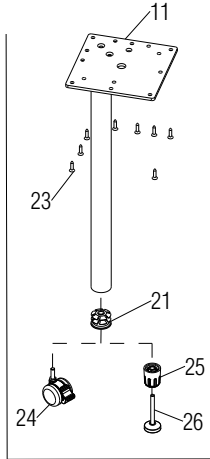

Item 2
(fixed height leg)

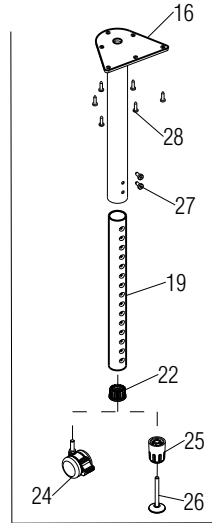

Item 3
(sit adj. height leg
for Kite and Diamond tables)

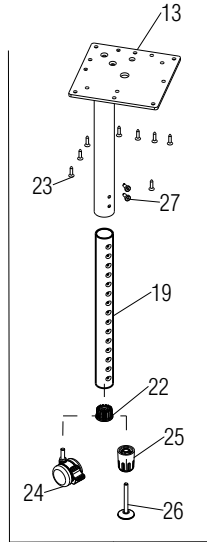

Item 4
(sit adj. height leg)

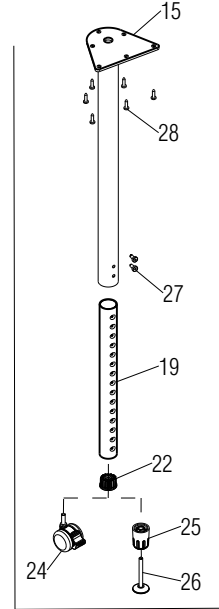

Item 5
(sit-stand adj. height leg
for Kite and Diamond tables)

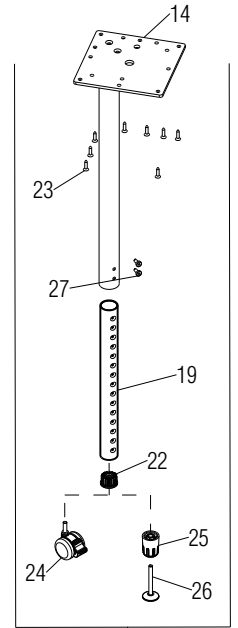

Item 6
(sit-stand adj. height leg)

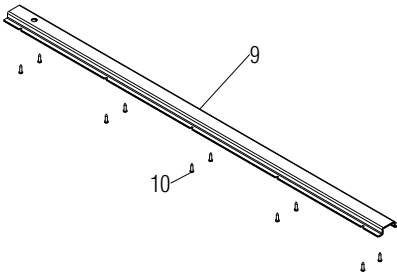

Item 34
(LH & RH tote rail kit)

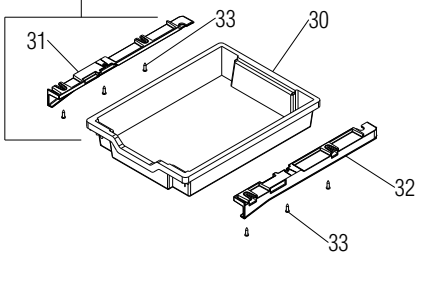

Item 35
(optional tote storage)

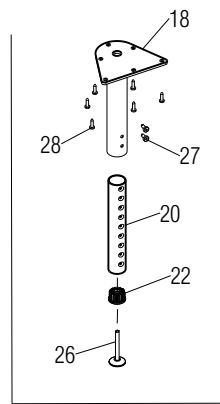

Item 7
(floor adj. height leg
for Kite and Diamond tables)

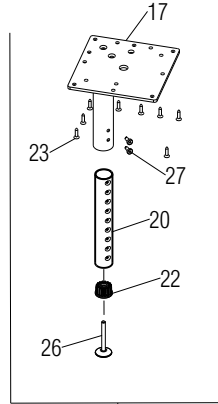

Item 8
(floor adj. height leg)

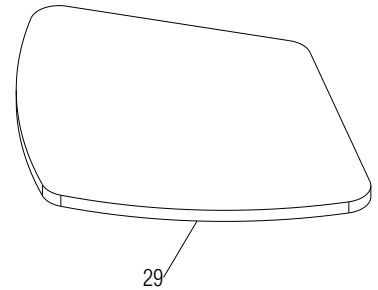

Ruckus® Activity Table
Parts Diagram

.XX = Select Color

* = See Price List for Pricing

Item quantities vary due to differences in table specifications.

Items 1-6: Caster Table Leg assemblies do not include Glide parts. Glide Table Leg assemblies do not include Caster parts.

Item 25 (felt or nylon spacers) is used with Item 26 (felt or nylon glides) only.

Item	Part Number	Item Description	Req Qty	Item	Part Number	Item Description	Req Qty
1	RDLEG	Fixed Kite & Diamond Table Leg, Caster (see note)	4	12	46.8013.XX	Weldment, Fixed Kite & Diamond Table Leg (29")	3-6
	RDLEG	Fixed Kite & Diamond Table Leg, Felt Glide (see note)	4	13	46.8012.16.XX	Upper Weldment, Sit Adj. Table Leg (20"-33")	3-6
	RDLEG	Fixed Kite & Diamond Table Leg, Nylon Glide (see note)	4	14	46.8012.25.XX	Upper Weldment, Sit-Stand Adj. Table Leg (29"-42")	3-6
2	RTLEG	Fixed Table Leg, Caster (see note)	3-6	15	46.8011.25.XX	Upper Weldment, Sit-Stand Adj. Kite & Diamond Table Leg (29"-42")	4
	RTLEG	Fixed Table Leg, Felt Glide (see note)	3-6	16	46.8011.16.XX	Upper Weldment, Sit Adj. Kite & Diamond Table Leg (20"-33")	4
	RTLEG	Fixed Table Leg, Nylon Glide (see note)	3-6	17	46.8412.XX	Upper Weldment, Floor Adj. Table Leg	3-4
3	RDLEG	Sit Adj. Kite & Diamond Table Leg, Caster (see note)	4	18	46.8414.XX	Upper Weldment, Floor Adj. Kite & Diamond Table Leg	4
	RDLEG	Sit Adj. Kite & Diamond Table Leg, Felt Glide (see note)	4	19	46.8000.XX	Leg Tube, Adjustable Lower	3-6
	RDLEG	Sit Adj. Kite & Diamond Table Leg, Nylon Glide (see note)	4	20	46.8410.XX	Leg Tube, Floor Adjustable Lower	3-4
4	RTLEG	Sit Adj. Table Leg, Caster (see note)	3-6	21	46.8003	Insert, Threaded, Ruckus Fixed Leg	3-6
	RTLEG	Sit Adj. Table Leg, Felt Glide (see note)	3-6	22	46.8002.BL	Insert, Threaded, Ruckus Adjustable Legs, Black	3-6
	RTLEG	Sit Adj. Table Leg, Nylon Glide (see note)	3-6	23	46.6670	Screw, #12 x 1" Phillips Flat Head Tapping	24-48
5	RDLEG	Sit-Stand Adj. Kite & Diamond Table Leg, Caster (see note)	4	24	46.8006.BL	Caster, 50mm Twin Wheel Locking, Black	2-6
	RDLEG	Sit-Stand Adj. Kite & Diamond Table Leg, Felt Glide (see note)	4	25	46.8024.F.BL	Spacer, Felt Glide Locking (used with item 14 felt glide) (see note)	1-6
	RDLEG	Sit-Stand Adj. Kite & Diamond Table Leg, Nylon Glide (see note)	4		46.8024.N.BL	Spacer, Nylon Glide Locking (used with item 14 nylon glide) (see note)	1-6
6	RTLEG	Sit-Stand Adj. Table Leg, Caster (see note)	3-6	26	46.8004.F	Glide, 5/16-18 x 3", Felt Base, Black (see note)	1-6
	RTLEG	Sit-Stand Adj. Table Leg, Felt Glide (see note)	3-6		46.8004.N	Glide, 5/16-18 x 3", Nylon Base, Black (see note)	1-6
	RTLEG	Sit-Stand Adj. Table Leg, Nylon Glide (see note)	3-6	27	46.8010.BL	Screw, 1/4-20 x .575" Hex Socket FTPH with Dog Point	6-12
7	RDLEG	Floor Adj. Kite & Diamond Table Leg, Felt Glide (see note)	4	28	12.0368.BL	Screw, #12 x 7/8", Pan Head, Black	24
	RDLEG	Floor Adj. Kite & Diamond Table Leg, Nylon Glide (see note)	4	29	Contact KI	Top, Ruckus Activity Table	1
8	RTLEG	Floor Adj. Table Leg, Felt Glide (see note)	3-4	30	2.80656.3TR	Tote, Removable 3" Deep, Translucent	1
	RTLEG	Floor Adj. Table Leg, Nylon Glide (see note)	3-4	31	46.8290.L	Tote Rail, Left-Hand Desk/Table Mounted with Stop	1
9	44.1657.46	Stiffener, Hat Channel, 46" (used on 60" long tables)	1-2	32	46.8290.R	Tote Rail, Right-Hand Desk/Table Mounted with Stop	1
	44.1657.52	Stiffener, Hat Channel, 52" (used on 72" long tables)	1-2	33	12.0160	Screw, #10 x 3/4" Phillips Pan Head	6
10	12.0272	Screw, #10 x 3/4" Pan Head Clear Zinc (used with stiffener only)	10-20	34	RKAU*	Rail Kit, Tote (includes LH & RH items 31, 32 & 33)	1
11	46.8014.XX	Weldment, Fixed Height Table Leg (29")	3-6	35	RKAU*	Kit, Tote Assembly (includes items 30 & 34)	1

